



# AIR WING®

AIR WING Kaze-Yoke

## Kaze-Yoke

**AIR WING prevents direct wind blasts and delivers a gentle, even temperature air flow to the entire room.**

AIR WING creates a comfortable living space by helping with problems like overly cold temperatures in summer, unevenly cold air near the floor in winter, and dryness from direct A/C wind.

**Easy, one-touch installation**

One-touch installation is so easy that anybody can do it. No screws or drilling is required, and there's no need to worry about damaging ceilings or walls.

**Adjust air flow direction to avoid direct wind blasts**

Freely regulate air flow direction and prevent unpleasant direct wind. AIR WING is 180 degrees vertically adjustable to an angle of your liking.

**Balanced temperature & energy efficiency**

More efficient air circulation to create an even temperature throughout the room, and also help you save energy.

**Winter & summer  
Suitable for all seasons**

Convenient all year round, simply adjust the wing angle to control both cool and hot air flow direction.

Horizontal slit & S-shaped design to  
**PREVENT CONDENSATION**



Prevents skin dryness



Protects your throat



For babies



Bedrooms for seniors

Works with all  
air conditioner  
types.



Wall mounted type



Ceiling cassette type



Round diffuser type

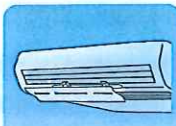

Ceiling suspended type



Floor-standing type

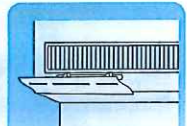

Wall diffuser type



**One-touch  
installation**

# A simple stylish wing to prevent direct hitting of airflow from your A/C!

Direct cool air further away and hot air towards the ground for more efficient air circulation, sending an even temperature comfortable breeze to every corner of the room.

## Freely adjustable wind direction

Adjust the arm part 180 degrees back and forth, or up and down, to freely change the A/C wind direction. Convenient all seasons for adjusting both hot and cool air flow.

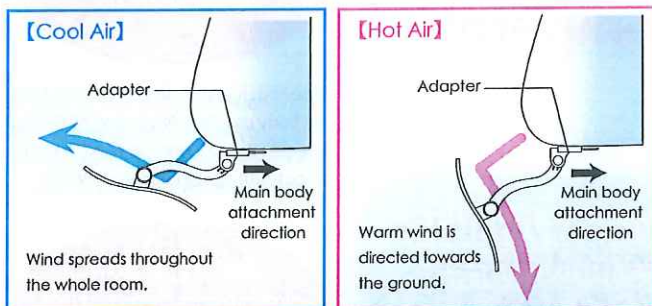

Example of the adapter position and main body attachment direction.

## Easy, one-touch installation

Simply attach the adapter where you want your AIR WING to be mounted and click the joint part of the AIR WING main body into the opening provided. No need for professional assistance, AIR WING is easy to install for anybody.

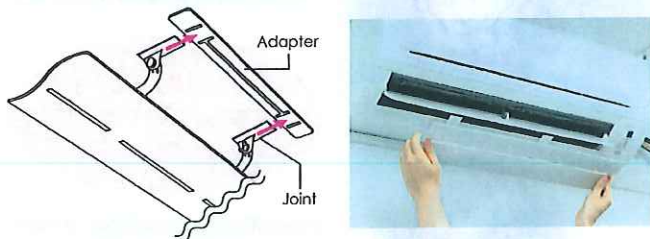

AIR WING can be used with almost all types of air conditioners.\*1 Moreover, installation does not require screws, drilling new holes, or any other modifications.\*2 There is no need to worry about damaging your ceiling or walls. Anybody can install AIR WING, with just one touch.

\*1 Ceiling cassette type, ceiling suspended type, wall mounted type, floor-standing type, round diffuser type, wall diffuser type

\*2 Before attaching AIR WING, wipe the target surface with water or a mild detergent, and let it dry fully. In case of using a detergent, make sure to wipe it off completely with a wet cloth. Do not remove and try to re-attach the adapter as it might cause risk of it losing its grip and falling off.

## Strong, sophisticated design

The S-shaped wing plate is designed with the wind flow in mind, simple and sophisticated to easily match your A/C unit. The design is light but strong.

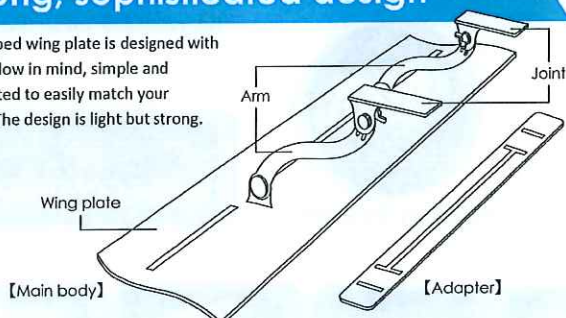

## Slit & S-shaped design Condensation Protection

The slit openings in the wing and its S-shaped design help to prevent condensation. There is no need to worry, even if the temperature difference between the room and the A/C settings is quite big. (Patent registered)

## Better air circulation & even temperature

Directing cool air further away and hot air towards the ground makes for more efficient air circulation throughout the whole room. It keeps the air temperature in the room balanced and helps to save energy, no matter what season it is.

Changing your A/C settings by just one degree can help save as much as 10% on your electricity bill. Tokyo Metropolitan Industrial Technology Research Institute has conducted tests that prove the efficiency of AIR WING in keeping the room temperature even.

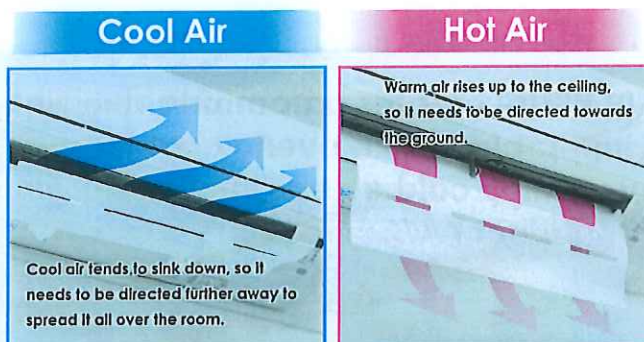

## AIR WING at the office

AIR WING's special adapter makes it compatible with ceiling cassette type and other various types of air conditioners used at offices. Its simple design looks good at any workplace.

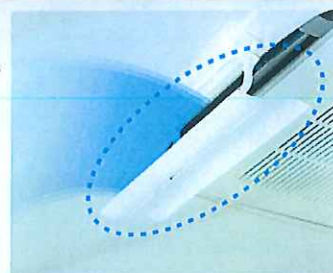

Product Specifications	
Product Name	AIR WING Kaze-Yoke
Main Body	Size: L 120mm x W 500mm x H 33mm 1 unit Material: polypropylene
Adapter	Size: L 40mm x W 340mm 1 unit (adhesive tape attached) Material: ABS resin
Product Number	AW16-021-01
Color	White
JAN Code	4571 103700846
Manufacturer	Japan

\*Other listed company names and product names are trademarks or registered trademarks of their respective companies.  
\*Features and specifications listed may be subject to change without prior notice for product improvement.

## Contact Us



株式会社ダイアン・サービス

AW16021011506